



VILLAGE ESTATES

• EST.1993 •



93 Main Road, Sidcup, Kent DA14 6ND

Tel: 0208 302 1002

www.village-estates.com

Email: sidcup@village-estates.com



NO ONWARD CHAIN

IDEAL FIRST TIME BUY

BRAND NEW BOILER

PARKING

EXCELLENT AMENITIES

GREAT LOCATION



Flat 4, 67 Station Road
Sidcup, DA15 7DR

Offers in Excess of
£225,000

NO ONWARD CHAIN! Village Estates are delighted to present this beautiful one bedroom property based close to all amenities and Sidcup station. Boasting excellent transport links as well as its own parking, this property is ideal for any first-time buyers or investors. The home offers a double bedroom, spacious living room as well as a modern kitchen and bathroom. We highly recommend viewing this fantastic opportunity.

EPC RATING: C

COUNCIL TAX BAND: C

TENURE: Leasehold

LEASE TERM: 160 Year Lease



Station Road, DA15

Approximate Gross Internal Area = 37.8 sq m / 408 sq ft

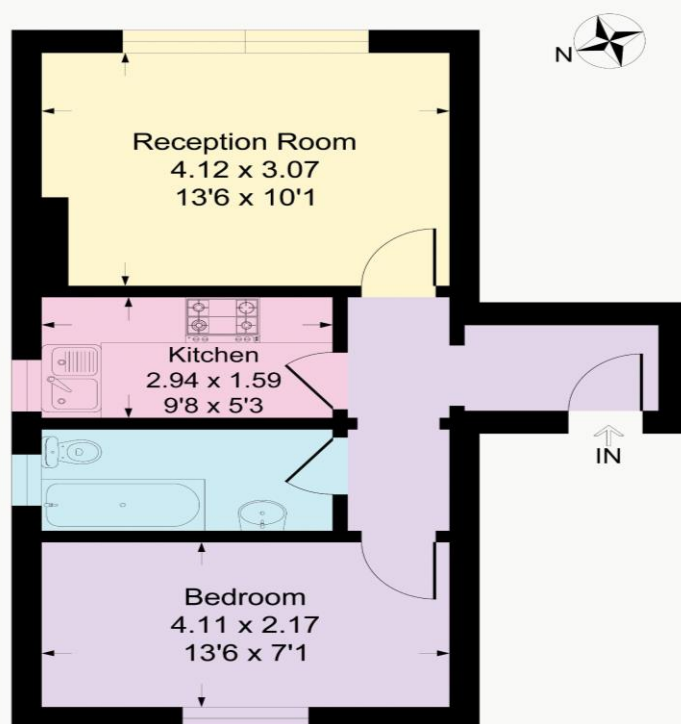

First Floor

CONSUMER PROTECTION FROM UNFAIR TRADING REGULATIONS 2008

Please note that any services, heating system or appliances have not been tested, and no warranty can be given or implied as to their working order. You are advised to obtain verification from your solicitor or surveyor. References to the tenure of a property are based on information supplied by the seller. We have not had sight of the title documents and a buyer is advised to obtain verification from their solicitor. Items shown in photographs are not included unless specifically mentioned within the sales particulars, but may be available by separate negotiation. Whilst every attempt has been made to ensure the accuracy of the floor plan contained here, measurements of doors, windows, rooms and any other items are approximate and no responsibility is taken for any error, omission, or mis-statement. We advise you to book an appointment to view before embarking on any journey to see a property, and check its availability. The accuracy of these details are not guaranteed and they do not form part of the contract.